

Butt hinge

→ For flush doors,
size 80 mm

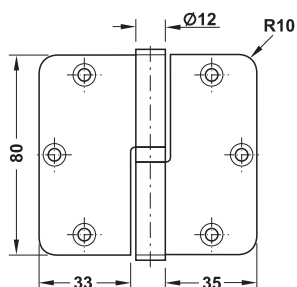

DIN left



- Area of application: For wooden or metal frames, for flush wooden or metal interior doors
- Door weight: ≤48 kg with 3 door hinges
- Knuckle Ø: 12 mm
- Flange thickness: 2.5 mm
- Bearing: With fixed pin and ball bearing with intermediate ring

Installation

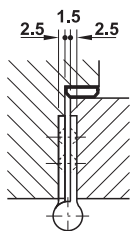

Material	Finish	DIN left	DIN right
Stainless steel	Matt	926.20.303	926.20.203
Brass	Polished	926.20.380	926.20.280

Order reference

Fixing screws for wooden frames and doors supplied.

Butt hinge

→ For flush doors,
size 80 mm

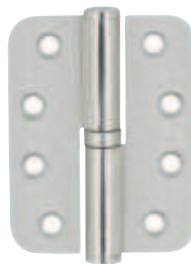

DIN left

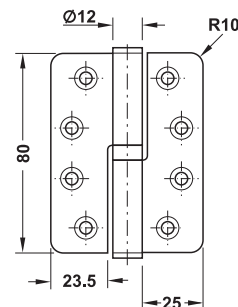

- Area of application: For wooden or metal frames, for flush wooden or metal interior doors
- Door weight: ≤40 kg with 3 door hinges
- Knuckle Ø: 12 mm
- Flange thickness: 2.5 mm
- Bearing: With fixed pin and ball bearing with intermediate ring

Installation

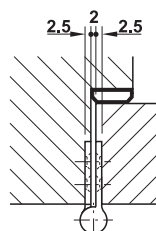

Material	Finish	DIN left	DIN right
Stainless steel	Matt	926.20.503	926.20.403
Brass	Polished	926.20.580	926.20.480

Order reference

Fixing screws for wooden frames and doors supplied.

Butt hinge

→ For flush doors,
size 100 mm

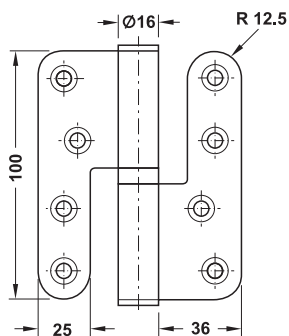

DIN left

- Area of application: For wooden or metal frames, for flush wooden or metal interior doors
- Door weight: ≤68 kg with 3 door hinges
- Knuckle Ø: 16 mm
- Flange thickness: 3 mm
- Bearing: With fixed pin and ball bearing with intermediate ring

Installation

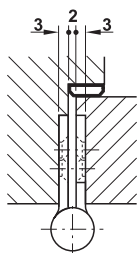

Material	Finish	DIN left	DIN right
Stainless steel	Matt	926.20.103	926.20.003
Brass	Polished	926.20.180	926.20.080
	Chrome plated matt	926.20.141	926.20.041

Order reference

Fixing screws for wooden frames and doors supplied.

Butt hinge

→ Rising/falling for flush doors,
size 101 mm

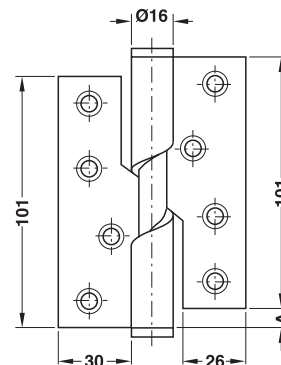
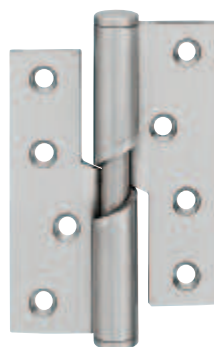

Rising DIN right

A = 9 mm with
180° opening angle

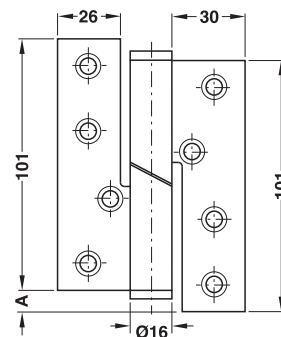

Falling DIN right

A = 9 mm with
180° opening angle

- Area of application: For wooden or metal frames, for flush wooden or metal interior doors
- Door weight: ≤40 kg
- Knuckle Ø: 16 mm
- Pin Ø: 10 mm
- Flange thickness: 3 mm
- Bearing: With fixed pin

Installation

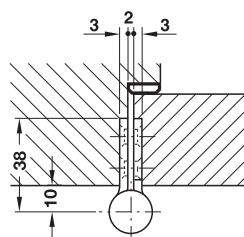

Material	Finish	Version	DIN left	DIN right
Stainless steel	Matt	Rising	926.26.003	926.26.103
		Falling	926.26.203	926.26.303

Packing: 2 pieces

Order reference

Fixing screws for wooden frames and doors supplied.

Butt hinge

→ For flush doors,
size 76 mm

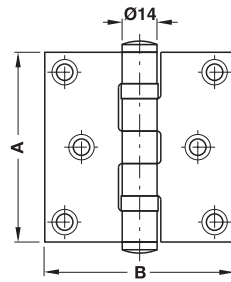
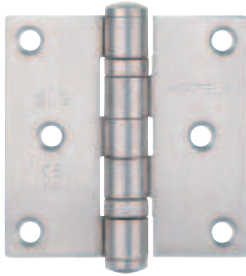

- Area of application: For wooden or metal frames, for flush wooden or metal interior doors
- Material: Stainless steel
- Door weight: 80 kg
- Knuckle Ø: 14 mm
- Flange thickness: 3 mm
- Flange shape: Square
- Bearing: With fixed pin, knuckle with two ball bearings
- Mounting: For DIN left hand and DIN right hand use
- Standard: Certified in compliance with EN 1935:2002
- Class:

4	7	4	1	1	4	0	11
---	---	---	---	---	---	---	----

Installation

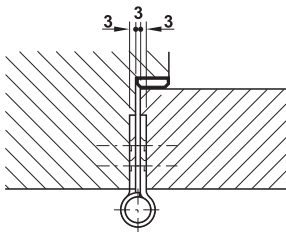

Finish	Dim. A mm	Dim. B mm	Cat. No.
Matt	76 mm/3"	76 mm/3"	926.33.003

Order reference

Fixing screws for wooden frames and doors supplied. Please order fixing screws for metal frames and doors Cat. No. 020.00.136 separately.

Butt hinge

→ For flush doors,
size 102 mm and 127 mm

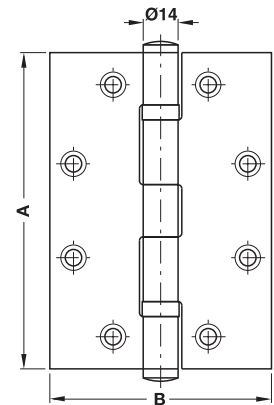
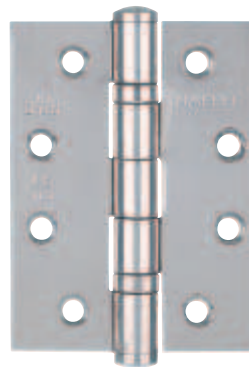

- Area of application: For wooden or metal frames, for flush wooden or metal interior doors
- Material: Stainless steel
- Door weight: 120 kg
- Knuckle Ø: 14 mm
- Flange thickness: 3 mm
- Flange shape: Square or rounded (optional) (radius 10 mm)
- Bearing: With fixed pin, knuckle with two ball bearings
- Mounting: For DIN left hand and DIN right hand use
- Standard: Certified in compliance with EN 1935:2002
- Class:

4	7	6	1	1	4	0	13
---	---	---	---	---	---	---	----

Installation

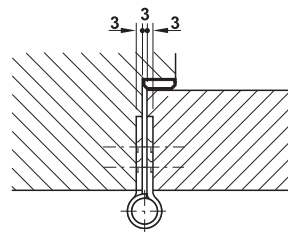

Flange shape	Finish	Dim. A mm	Dim. B mm	Cat. No.
Square	Polished	102 mm/4"	76 mm/3"	926.33.102
			89 mm/3.5"	926.33.202
	Matt	102 mm/4"	76 mm/3"	926.90.203
			89 mm/3.5"	926.33.203
			102 mm/4"	926.33.303
	Brass plated polished	102 mm/4"	89 mm/3.5"	926.33.403
			89 mm/3.5"	926.33.486
	Brass plated burnished	102 mm/4"	76 mm/3"	926.90.280
			89 mm/3.5"	926.33.286
	Rounded	Matt	102 mm/4"	76 mm/3"
89 mm/3.5"				926.33.287
Brass plated polished		102 mm/4"	76 mm/3"	926.90.213
			76 mm/3"	926.90.290

Order reference

Fixing screws for wooden frames and doors supplied. Please order fixing screws for metal frames and doors Cat. No. 020.00.136 separately.

Intumescent fire protection kit for door hinges ▶ AH 4.17
▶ AH 6.25

DGH-B-INT 2010; HDE-en; 06/10; Dimensional data not binding. We reserve the right to alter specifications without notice.

Butt hinge

→ For flush doors,
size 114 mm

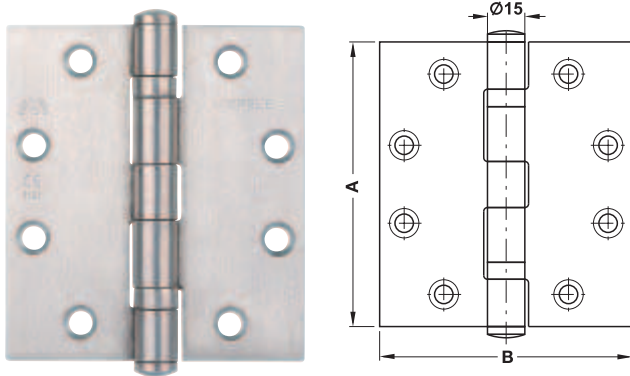

- Area of application: For wooden frames, for flush interior doors
- Material: Stainless steel
- Knuckle Ø: 15 mm
- Door weight: 120 kg
- Flange thickness: 3.5 mm
- Flange shape: Square
- Bearing: With fixed pin, knuckle with two ball bearings
- Mounting: For DIN left hand and DIN right hand use
- Standard: Certified in compliance with EN 1935:2002
- Class:

4	7	6	1	1	4	0	13
---	---	---	---	---	---	---	----

Installation

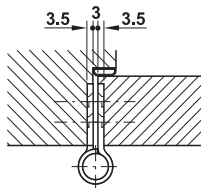

Finish	Dim. A mm	Dim. B mm	Cat. No.
Matt	114 mm/4.5"	102 mm/4"	926.33.503
		114 mm/4.5"	926.33.603

Order reference

Fixing screws for wooden frames and doors supplied.
Please order fixing screws for metal frames and doors
Cat. No. 926.22.300 separately.

Intumescent fire protection kit for door hinges

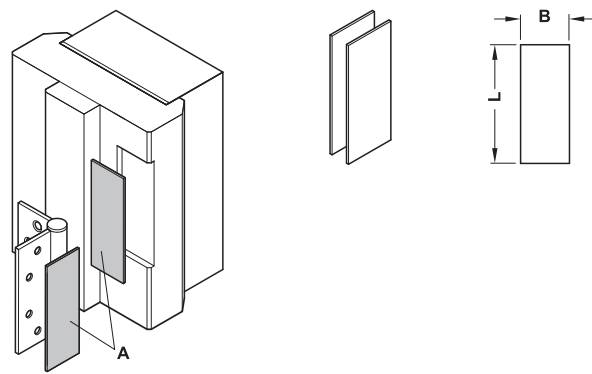

A = hinge protection kit

- Area of application: The material expands substantially when exposed to hot temperatures for protection of door hinges, providing fire resistance of up to 60 minutes
- Version: Shaped pads of intumescent material, self-adhesive, cut to size
- Material thickness: 2 mm
- Replaces intumescent mastic or paste

Note

The installation must comply with specifications and testing must have been carried out in accordance with EN 1634 in order to guarantee the fire resisting properties of the door. The applicable national and international guidelines, standards, approvals and other relevant regulations with regard to smoke control and fire resistance also have to be taken into consideration.

Dimensions (L x W) mm	Cat. No.
76 x 31	950.11.085
102 x 30	950.11.087
102 x 36	950.11.097
102 x 42	950.11.107
126 x 37	950.11.119
114 x 43	950.11.117
114 x 48	950.11.118

Packing: 1 set

Door hinges

▶ AH 4.16

Butt hinge
→ For flush doors

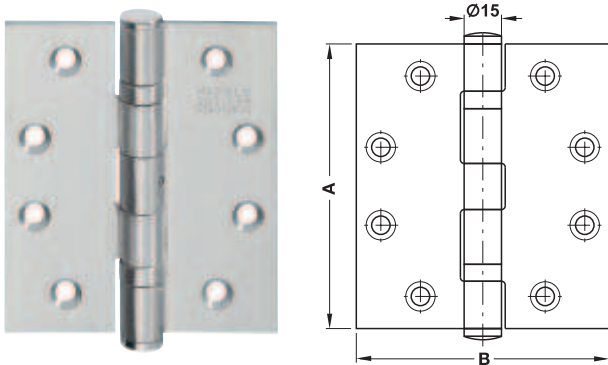

- Area of application: For wooden or metal frames, for flush wooden or metal doors
- Material: Stainless steel
- Knuckle Ø: 15 mm
- Flange thickness: 3 mm
- Flange shape: Square
- Bearing: With removable pin, knuckle with two ball bearings
- Mounting: For DIN left hand and DIN right hand use

4

Installation

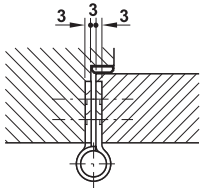

Finish	Dim. A	Dim. B	Door weight kg	Cat. No.
Matt	102 mm/4"	76 mm/3"	≤58 kg with 3 door hinges	926.29.603
Matt	102 mm/4"	89 mm/3.5"	≤61 kg with 3 door hinges	926.29.703

Packing: 2 pieces

Order reference

Fixing screws for wooden frames and doors supplied.
Please order fixing screws for metal frames and doors
Cat. No. 020.00.136 separately.

DGH-B-INT 2010; HDE-en, 06/10; Dimensional data not binding. We reserve the right to alter specifications without notice.

**DIESE SEITE WURDE BEWUSST
LEER GELASSEN**

INTENTIONAL BLANK PAGE

Butt hinge

→ Narrow, current-carrying

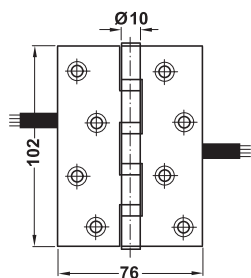
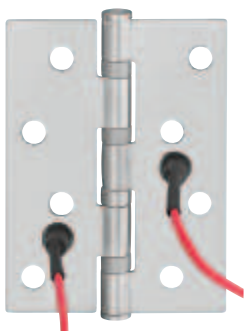

- Area of application: For transmitting current from the frame to the door (24 V), as centre hinge only, to be used with outer pair of compatible hinges
- Material: Stainless steel
- Knuckle Ø: 10 mm
- Flange thickness: 2.5 mm
- Flange shape: Square
- Door thickness: ≥35 mm
- Version: With 4-core cable

Installation

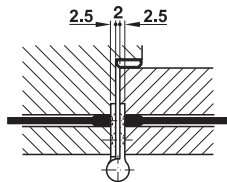

Material	Finish	Mounting	Cat. No.
Stainless steel	Matt	DIN left	921.09.111
		DIN right	921.09.110

Order reference

Fixing screws for wooden frames and doors supplied.

Butt hinge

→ Extra heavy duty hinge for flush doors, size 102 mm

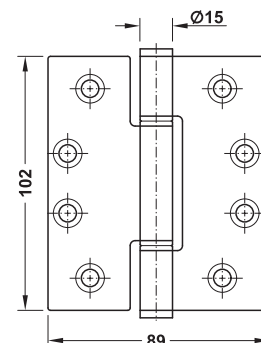
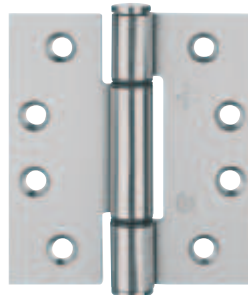

- Area of application: For wooden or metal frames, for flush wooden or metal doors (stainless steel quality AISI 316)
- Door weight: ≤160 kg
- Knuckle Ø: 15 mm
- Flange thickness: 3 mm
- Bearing: With removable security pin, maintenance-free friction bearing
- Mounting: For DIN left hand and DIN right hand use
Certified in compliance with EN 1935:2002
- Standard:
- Class:

4	7	7	1	1	4	1	14
---	---	---	---	---	---	---	----

Installation

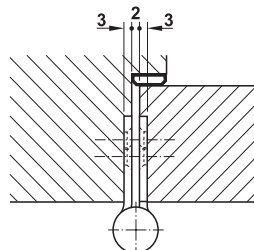

Material	Finish	Cat. No.
Stainless steel	Matt	926.94.703

DGH-B-INT 2010, HDE-en, 06/10; Dimensional data not binding. We reserve the right to alter specifications without notice.

Butt hinge

→ For rebated doors,
size 102 mm

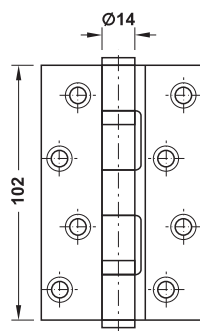

- Area of application: For wooden or metal frames, for flush wooden or metal interior doors
- Door weight: ≤58 kg with 3 door hinges
- Knuckle Ø: 14 mm
- Flange thickness: 3 mm
- Bearing: With fixed pin, knuckle with two ball bearings
- Mounting: Suitable for DIN left hand and DIN right hand

Installation

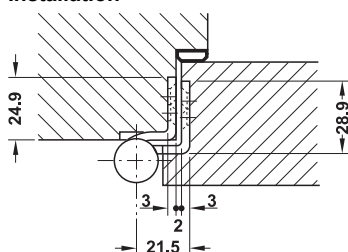

Material	Finish	Cat. No.
Stainless steel	Matt	926.25.803
Brass	Polished	926.25.880

Order reference

Fixing screws for wooden frames and doors supplied.

Butt hinge

→ For flush mounting,
size 102 mm

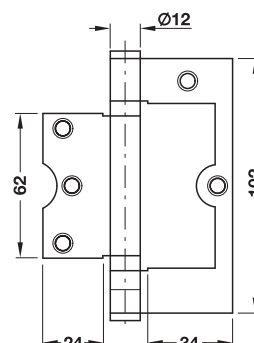
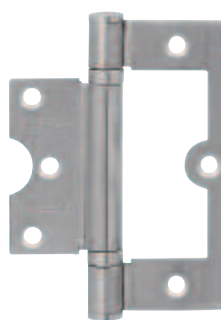

- Area of application: For wooden or metal frames, for flush wooden or metal interior doors, For flush mounting
- Door weight: ≤60 kg
- Knuckle Ø: 12 mm
- Flange thickness: 2.5 mm
- Bearing: Knuckle with 2 ball bearings
- Routing height: 102 mm
- Routing depth: 2.65 mm
- Mounting: Suitable for DIN left hand and DIN right hand

Installation

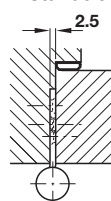

Material	Finish	Cat. No.
Stainless steel	Matt	926.22.103

Order reference

Fixing screws for wooden frames and doors supplied.

Butt hinge
→ For flush doors,
size 127 mm

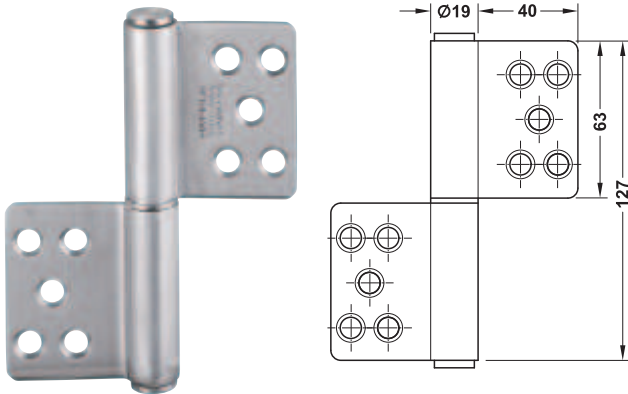

Installation

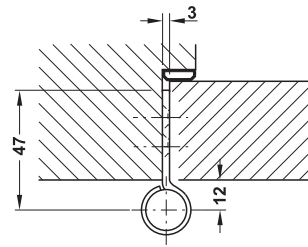

Material	Finish	Cat. No.
Stainless steel	Matt	926.13.903

Order reference

Fixing screws for wooden frames and doors supplied.

- Area of application: For wooden or metal frames, for flush wooden or metal interior doors
- Door weight: ≤80 kg with 3 door hinges
- Knuckle Ø: 14 mm
- Flange thickness: 3 mm
- Bearing: With fixed pin and intermediate ring
- Mounting: Suitable for DIN left hand and DIN right hand
- Routing height: 127 mm

Butt hinge

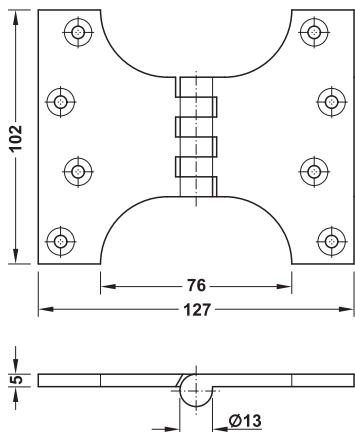
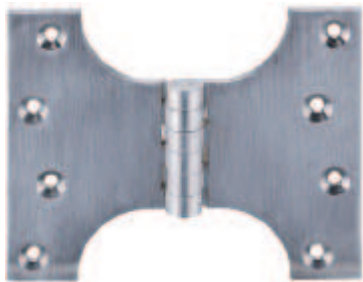

- Area of application: For wooden or metal frames, for wooden or metal interior doors, for light duty use, not suitable for extremely wide doors
- Material: Brass
- Knuckle Ø: 13 mm
- Flange thickness: 5 mm
- Bearing: With fixed pin
- Mounting: Suitable for DIN left hand and DIN right hand

Installation

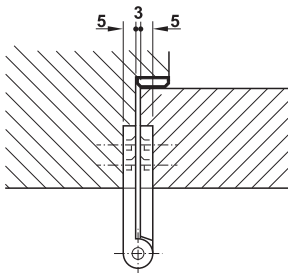

Dim. A mm	Dim. B mm	Finish	Cat. No.
76	127	Polished	921.08.590
		Chrome plated, satin finish	921.08.594
102	152	Polished	921.08.610
		Chrome plated, satin finish	921.08.614

Butt hinge

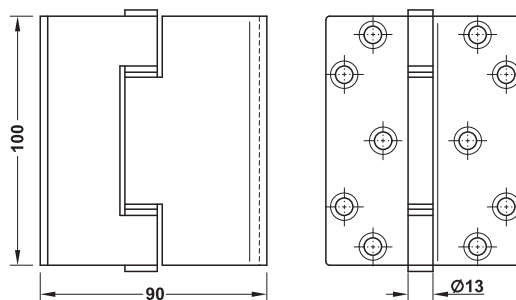

- Area of application: Prevents damages to both doors and fittings, permits wide objects such as hospital beds or wheelchairs to pass freely, the hinge when opened 90° will position the door outside the line of the door stop
- Size: 100 mm
- Door thickness: 35 – 45 mm
- Door weight: ≤80 kg
- Knuckle Ø: 13 mm
- Material: Steel

Installation

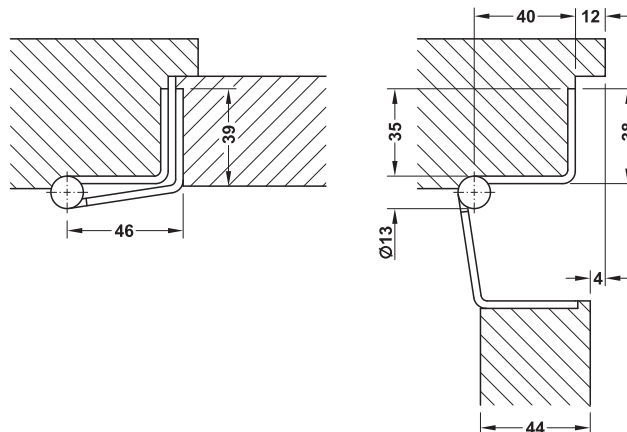

Finish	Cat. No.
Galvanized	926.88.165

DGH-B-INT 2010, HDE-en, 06/10; Dimensional data not binding. We reserve the right to alter specifications without notice.