

Bracket with load bearing capacity of 30–50 kg per pair

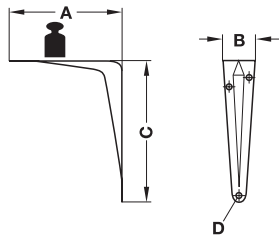

> Material: Steel
 > Load bearing capacity: Per piece, tested to DIN EN 16337:2013-08 with 1.7 kg plate for impact test, i.e. double load bearing capacity with surface load and 2 supports, shelf size must suit the respective bracket depth

Load bearing capacity kg	Dim. A mm	Dim. B mm	Dim. C mm	Dim. D mm	White coated
15	65	31	90	4.5	287.30.111
	90	33	115	4.5	287.30.120
	110	35	140	4.5	287.30.129
17.5	130	40	195	4.5	287.30.147
	185	43	245	4.5	287.30.165
22.5	230	43	295	4.5	287.30.174
25	280	43	345	4.5	287.30.185

Packing: 1 or 20 pieces

Note

Max. distance between two brackets: 700 mm.

The specified load bearing capacity applies only with even load distribution (surface load) and proper and reliable attachment to the wall.

Bracket with load bearing capacity of 30–80 kg per pair

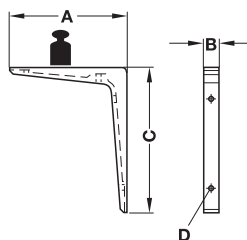

> Material: Aluminium
 > Load bearing capacity: Per piece, tested to DIN EN 16337:2013-08 with 1.7 kg plate for impact test, i.e. double load bearing capacity with surface load and 2 supports, shelf size must suit the respective bracket depth

Load bearing capacity kg	Dim. A mm	Dim. B mm	Dim. C mm	Dim. D mm	White coated
15	100	20	150	5	287.35.722
25	150	20	200	5	287.35.741
	200	24	250	5	287.35.750
40	200	26	300	6	287.35.759

Packing: 1 or 10 pieces

Note

Max. distance between two brackets: 700 mm.

The specified load bearing capacity applies only with even load distribution (surface load) and proper and reliable attachment to the wall.

Bracket with load bearing capacity of 25–30 kg per pair

Forged

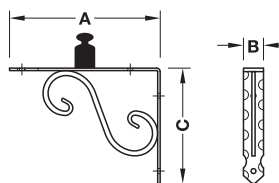

> Material: Steel
 > Load bearing capacity: Per piece, tested to DIN EN 16337:2013-08 with 1.7 kg plate for impact test, i.e. double load bearing capacity with surface load and 2 supports, shelf size must suit the respective bracket depth

Load bearing capacity kg	Dim. A mm	Dim. B mm	Dim. C mm	Antique black
15	150	20	115	287.31.370
	200	20	150	287.31.371
12.5	280	20	200	287.31.372

Packing: 2 pieces

Note

Max. distance between two brackets: 700 mm.

The specified load bearing capacity applies only with even load distribution (surface load) and proper and reliable attachment to the wall.

Bracket with load bearing capacity of 300 kg per pair



3

Shelf Supports



> Material: Steel
 > Load bearing capacity: 150 kg per piece, tested to DIN EN 16337:2013-08 with 1.7 kg plate for impact test, i.e. 300 kg load bearing capacity with surface load and 2 supports, shelf size must suit the respective bracket

Dim. A mm	Dim. B mm	Dim. C mm	White coated
298	30	205	287.31.755
397	30	267	287.31.756
496	30	328	287.31.757

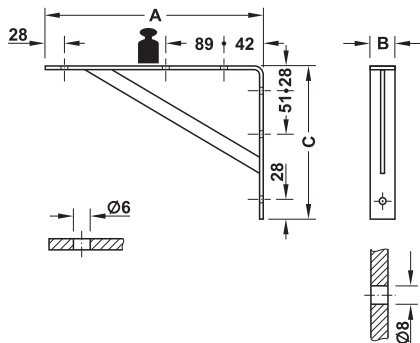

Packing: 1 or 10 pieces

Note

Max. distance between two brackets: 800 mm
 The specified load bearing capacity applies only with even load distribution (surface load) and proper and reliable attachment to the wall.

Fixing holes for top mounting

Fixing holes for wall mounting

Hebgo Bracket with load bearing capacity of 150 or 500 kg per pair



> Material: Steel
 > Load bearing capacity: Per piece, tested to DIN EN 16337:2013-08 with 1.7 kg plate for impact test (with load bearing capacity 75 kg) or 2.5 kg plate for impact test (with load bearing capacity 250 kg), i.e. double load bearing capacity with surface load and 2 supports, shelf size must suit the respective bracket depth

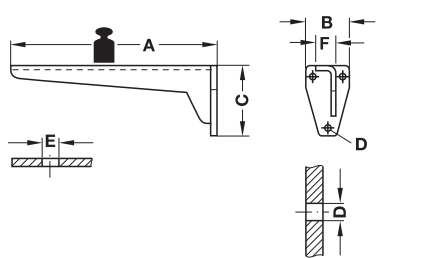

Fixing holes for top mounting

Fixing holes for wall mounting

Load bearing capacity kg	Dim. A	Dim. B	Dim. C	Dim. D	Dim. E	Dim. F	Grey primed	Galvanized
	mm	mm	mm	mm	mm	mm		
75	200	46	80	8	5	20	287.44.416	–
	240	46	80	8	5	20	287.44.425	–
	280	53	100	8	6	22	287.44.434	–
	330	53	100	8	6	22	287.44.443	287.44.943
	380	65	130	10	6	25	287.44.452	287.44.952
	480	65	130	10	6	25	287.44.461	287.44.961
	580	82	170	10	6	30	287.44.470	287.44.970
	680	82	170	10	6	30	287.44.489	–
250	380	80	180	12	6	32	287.45.459	–
	480	80	180	12	6	32	287.45.468	287.45.968
	580	100	220	15	6	40	287.45.477	–
	680	100	220	15	6	40	287.45.486	–
	780	100	220	15	6	40	287.45.495	–

Packing: 1 piece

Note

Tested distance between two brackets:
 With load bearing capacity 75 kg/piece: 600–750 mm
 With load bearing capacity 250 kg/piece: 850–950 mm
 The specified load bearing capacity applies only with even load distribution (surface load) and proper and reliable attachment to the wall.

DGH-M-INT 2020, HDE-en, 05/19; Dimensional data not binding. We reserve the right to alter specifications without notice.

Bracket

Folding

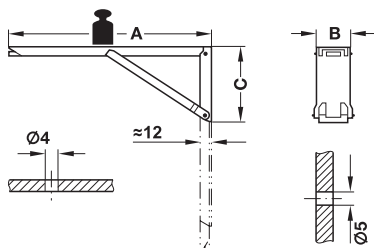

Mounting holes
for plate

Mounting holes
for wall

> Version: With locking mechanism and spring-loaded support

Functionality

Press integral release button to fold down.

Material	Finish	Dim. A mm	Dim. B mm	Dim. C mm	Packing pieces	Cat. No.
Steel	Yellow chromatized	250	25	85	2 or 40	287.41.906
		380	25	120	2 or 10	287.41.915
Stainless steel	–	250	25	85	1 or 40	287.41.600



3

Shelf Supports

Bracket with load bearing capacity of 30–60 kg per pair

Folding

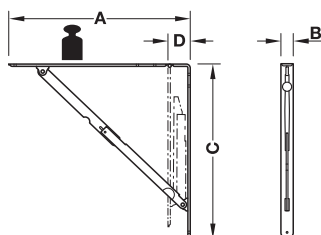

- > Load bearing capacity: Per piece, tested to DIN EN 16337:2013-08 with 1.7 kg plate for impact test, i.e. double load bearing capacity with surface load and 2 supports, shelf size must suit the respective bracket depth
- > Material: Steel
- > Version: With locking mechanism

Functionality

To raise bracket lift support arm and allow to engage.

To fold down bracket lift support arm and push locking arm backwards.

Load bearing capacity kg	Dim. A mm	Dim. B mm	Dim. C mm	Dim. D mm	Screw hole Ø	White coated, similar to RAL 9003
15	210	24	200	40	5	287.40.740
25	320	30	310	45	5	287.40.741
30	430	30	410	55	5	287.40.742

Packing: 2 pieces

Note

Max. distance between two brackets: 600 mm.

The specified load bearing capacity applies only with even load distribution (surface load) and proper and reliable attachment to the wall.

Bracket with load bearing capacity of 100 kg per pair

Folding



- > Material: Steel
- > Load bearing capacity: 50 kg per piece, tested to DIN EN 16337:2013-08 with 2.5 kg plate for impact test, i.e. 100 kg load bearing capacity with surface load and 2 supports
- > Colour: White
- > Finish: Support: Galvanized
- > Version: With locking mechanism



3

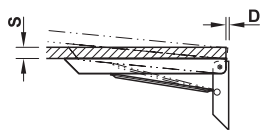
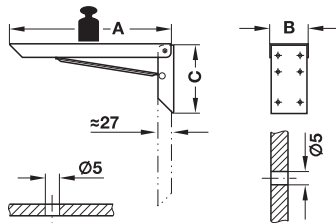

S mm	D mm
≤10	≥2.2
≤15	≥2.6
≤20	≥3.1
≤25	≥3.6
≤30	≥4.1

Functionality

To raise bracket lift support arm and allow to engage.

To fold down bracket slightly lift support arm and release locking mechanism.

Dim. A mm	Dim. B mm	Dim. C mm	White coated
200	61	115	287.54.721
250	61	115	287.54.726
300	61	115	287.54.731

Packing: 2 pieces

Note

Max. distance between two brackets: 600 mm.

The specified load bearing capacity applies only with even load distribution (surface load) and proper and reliable attachment to the wall.

Shelf Supports

Bracket

Folding



- > Material: Steel
- > Version: With locking mechanism adjustable in 3 positions

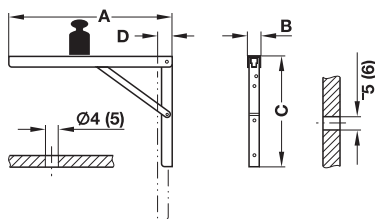

Fixing holes for top mounting

Fixing holes for wall mounting

Dim. in brackets apply to dim. A = 400 mm

Adjustment facility

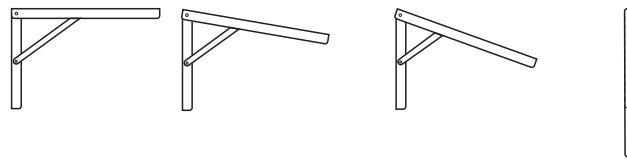

Position 1 = 90° Position 2 = 80° Position 3 = 70° Position 4 = 0°

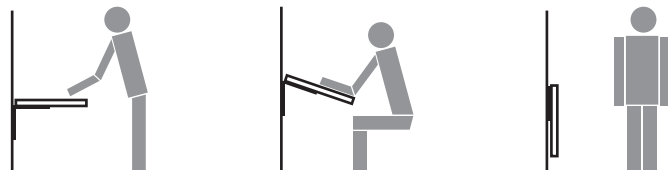

Functionality

To raise bracket lift support arm and allow to engage at required position.

To fold down bracket lift support arm and release locking mechanism.

Dim. A mm	Dim. B mm	Dim. C mm	Dim. D mm	Galvanized	White coated
300	30	200	25	287.55.930	287.55.730
400	36	270	32	287.55.940	287.55.740

Packing: 2 pieces

Bracket with load bearing capacity of 100 kg per pair

Folding



- > Material: Steel
- > Load bearing capacity: 50 kg per pair, tested to DIN EN 16337:2013-08 with 2.5 kg plate for impact test, i.e. 100 kg load bearing capacity with surface load and 2 supports
- > Version: With locking mechanism

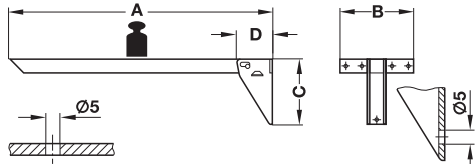

Fixing holes for top mounting

Fixing holes for wall mounting

Functionality

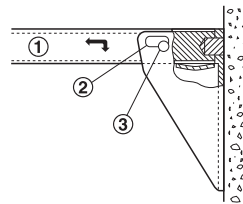

- ① Folding support arm
- ② Pivot aperture
- ③ Locking pin

To raise bracket lift support arm and push in.
To fold down bracket lift support arm and pull forward.

Dim. A mm	Dim. B mm	Dim. C mm	Dim. D mm	Brown coated
360	140	120	64	287.48.110
460	140	120	64	287.48.129
560	140	120	64	287.48.138
660	140	120	64	287.48.147

Packing: 2 pieces

Note

Max. distance between two brackets: 600 mm.

The specified load bearing capacity applies only with even load distribution (surface load) and proper and reliable attachment to the wall.

Hebgo Bracket with load bearing capacity of 150 kg per pair

Folding



- > Material: Steel
- > Load bearing capacity: 75 kg per piece, tested to DIN EN 16337:2013-08 with 1.7 kg plate for impact test, i.e. 150 kg load bearing capacity with surface load and 2 supports, shelf size must suit the respective bracket depth
- > Version: With locking mechanism

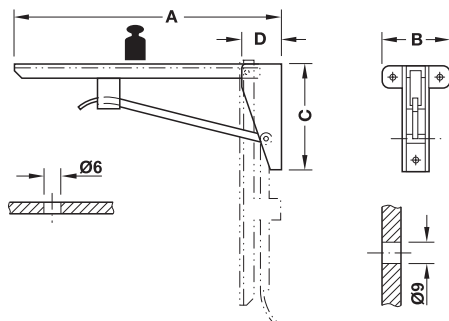

Fixing holes for top mounting

Fixing holes for wall mounting

Functionality

To raise bracket lift support arm and allow to engage automatically.
To fold down bracket lift support arm and release locking mechanism.

Note

Tested distance between two brackets: 700–750 mm

Dim. A mm	Dim. B mm	Dim. C mm	Dim. D mm	Grey primed
330	82	134	50	287.42.403
380	82	134	50	287.42.412
480	82	152	50	287.42.421
580	82	178	50	287.42.430
680	82	178	50	287.42.449

Packing: 1 piece

Note

The specified load bearing capacity applies only with even load distribution (surface load) and proper and reliable attachment to the wall.



Hebgo Bracket with load bearing capacity of 500 kg per pair

Folding



- > Material: Steel
- > Load bearing capacity: 250 kg per piece, tested to DIN EN 16337:2013-08 with 2.5 kg plate for impact test, i.e. 500 kg load bearing capacity with surface load and 2 supports, shelf size must suit the respective bracket depth
- > Version: With locking mechanism



3

Shelf Supports

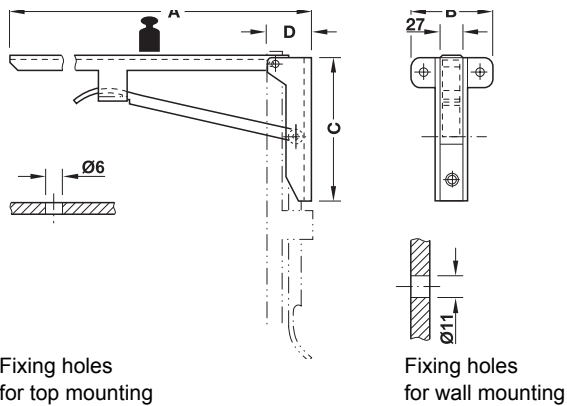

Fixing holes for top mounting

Fixing holes for wall mounting

Functionality

To raise bracket lift support arm and allow to engage automatically. To fold down bracket slightly lift support arm and release locking mechanism.

Note

- > Only use in pairs.
- > Tested distance between two brackets: 800–900 mm

Dim. A mm	Dim. B mm	Dim. C mm	Dim. D mm	Grey primed
420	115	180	60	287.43.400
480	115	180	60	287.43.419
580	115	220	60	287.43.428
680	115	220	60	287.43.437
780	115	220	60	287.43.446

Packing: 1 piece

Note

The specified load bearing capacity applies only with even load distribution (surface load) and proper and reliable attachment to the wall.

Hebgo Bracket for benches with load bearing capacity of 500 kg per pair

Folding

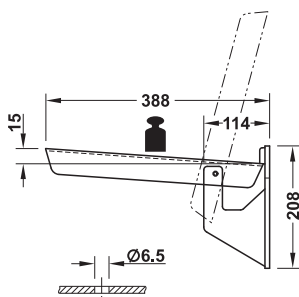
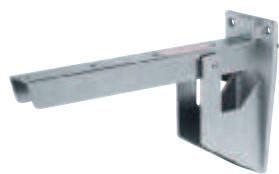

Fixing holes
for top mounting

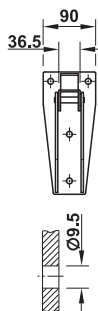

Fixing holes
for wall mounting

Note

Max. distance between two brackets: 700 mm.

The specified load bearing capacity applies only with even load distribution (surface load) and proper and reliable attachment to the wall.

- > Area of application: For benches
- > Material: Steel
- > Version: With or without pull-in spring

Installation

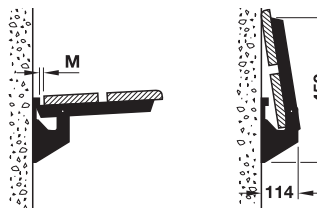

Note dimension M when installing to guarantee functionality.

- > Dimension M minimum value: 17 mm
- > Seat thickness: 30 mm
- > Effective length of support arm: 380 mm

	Hot-galvanized
Without pull-in spring	287.47.917
With pull-in spring	287.47.920

Packing: 1 piece



Bracket for benches with 400 kg load bearing capacity per pair

Folding

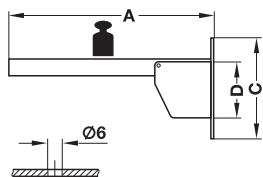

Fixing holes
for top mounting

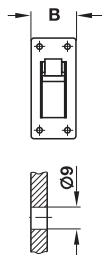

Fixing holes
for wall mounting

Note

Max. distance between 2 brackets: 700 mm.

The specified load bearing capacity applies only with even load distribution (surface load) and proper and reliable attachment to the wall.

- > Material: Steel

Installation

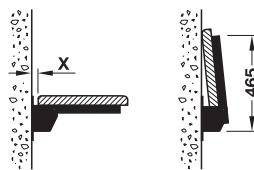

- > Panel thickness max. 45 mm
- > X = 20 mm (with panel thickness 25 mm)

Dim. A mm	Dim. B mm	Dim. C mm	Dim. D mm	Bright galvanized
360	80	180	100	287.53.936

Packing: 2 pieces

Bracket for table extension

Folding

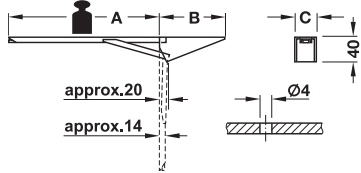

> Material: Steel



For extending table tops and worktops.
The sprung folding bracket automatically locks when raised.

Dim. A mm	Dim. B mm	Dim. C mm	Yellow chromated
280	130	30	287.41.951

Packing: 1 or 30 pieces



3

Shelf Supports